

# MS20 Magnet Range

**Order Code: MS20 DSU (-DS) - 2M (-vert)**

- **Architectural transom housing full door width or height**
- **Up to 300Kg hold force**
- **12V DC 250mA**
- **24V DC 500mA**
- **Long life, easily cleaned electroless nickel plated magnet and armature with satin anodised housing as standard**
- **RAL paint finishes can be specified**
- **Sliding door application ( armature in housing )**

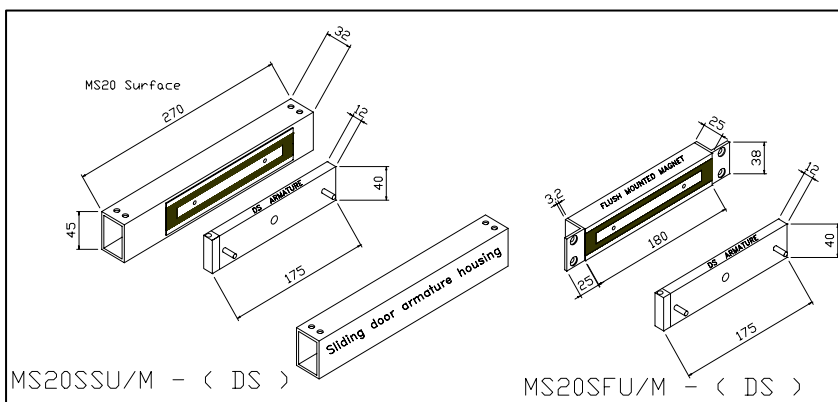
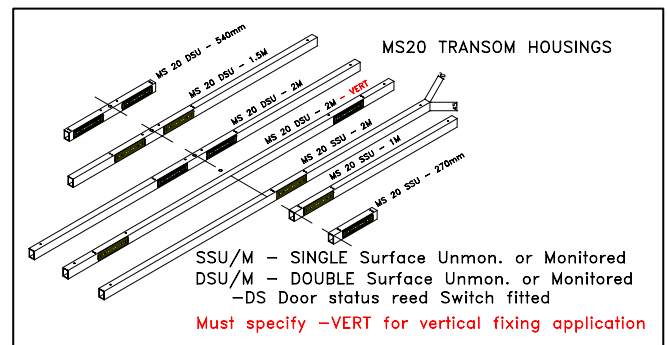

- **Monitoring options :-**
  - U = unmonitored**
  - M = magnetic monitored i.e. door `locked` or `not locked`**
  - DS = Door Status reed switch i.e. door `closed` or `not closed`**
  - Note: DS option can be used with both U & M versions**

- **Available in these following options:**

Double	<input checked="" type="checkbox"/>
Surface	<input checked="" type="checkbox"/>
Flush	<input checked="" type="checkbox"/>
Monitored	<input checked="" type="checkbox"/>
Door status	<input checked="" type="checkbox"/>

**Order Code:**

## Surface Mounted – in transom housing

**Single Surface** → MS20SS ☐      M = Monitored  
**Double Surface** → MS20DS ☐      U = Unmonitored

e.g. **MS20DS**U/M - **DS** - **Length** - **Vert**

↑  
**Door**  
**Status**↑  
1M / 2M↑  
For use in  
vertical mtg.

### Flush – only supplied as single

**Single Flush Unmonitored** → **MS20SFU**

Single **F**lush **M**onitored → **MS20SFM**

**Door Status monitoring** available on either of the above e.g. **MS20SFU - DS**



## Installation Diagrams

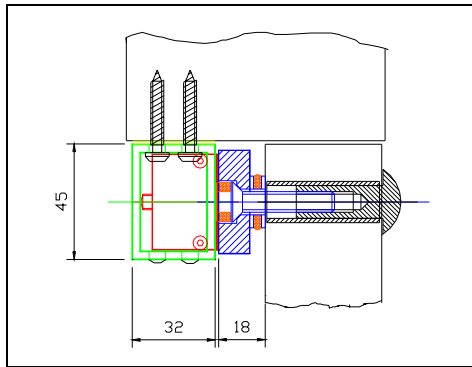

**Outward opening with large reveal**

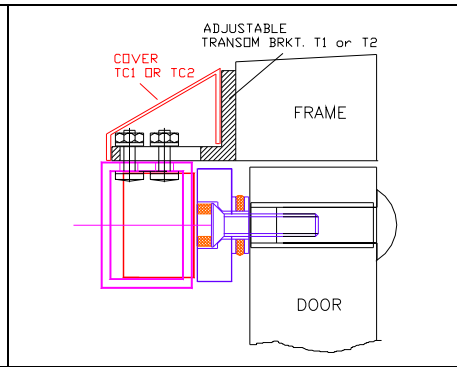

**Outward opening with no reveal  
using adjustable transom bracket  
T1/T2 with cover TC1/TC2**

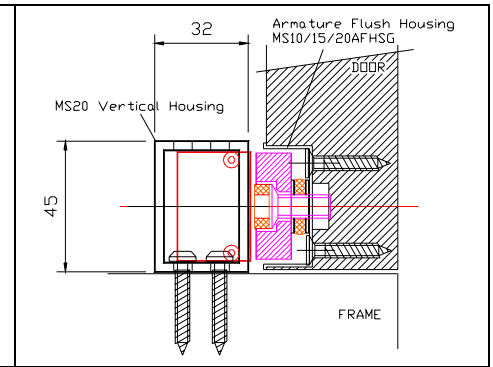

**Outward opening with flush mounted  
armature using armature flush  
housing MS10/15/20 AFHSG**

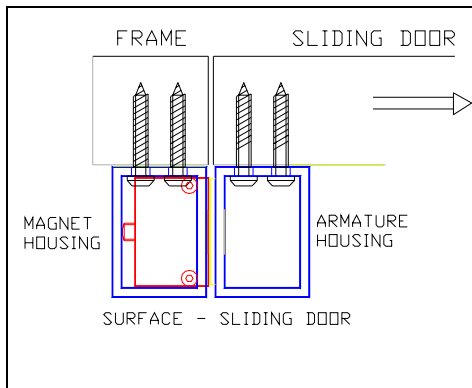

**Surface mounted on a sliding door**

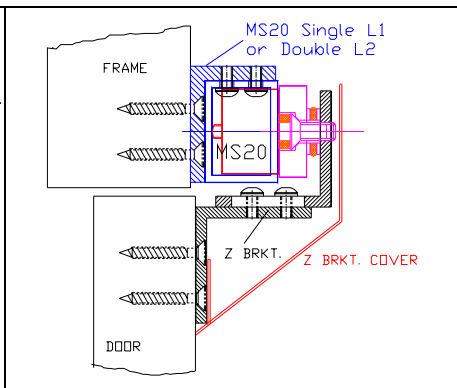

**Inward opening door using L Bracket  
L1 and Z bracket**

## Accessories – all sold separately

- Z & L1 or L2 brackets for Inward opening doors
- Adjustable ( T1 or T2) Transom brackets for Outward opening doors
- 4 types of armature mounting giving Flush or Surface options.
- Covers available for the Z and Transom brackets, hiding fixings.

Accessory	Order Code
L Bracket	MS20L1 (Single), MS20L2 (Double)
Z Bracket	MS10/15/20Z
Z Bracket Cover	MS10/15/20ZC
Armature housings (surface, bevelled edge, flush)	MS10/15/20 AMPTL, ARHSG, AFHSG
Adjustable Transom Bracket	MS10/15/20T1 (Single), MS10/15/20T2 (Double)
Transom Bracket Cover	MS10/15/20TC1